

**CLIENT**



**VAUGHAN**  
CONSTRUCTIONS  
PTY. LTD.



**HEAD & HUMPHREYS**  
LAND CONSULTANTS  
Suite 3, 47 Railway Road  
P.O. Box 63, Blackburn 3130  
Tel: 9875 8777 Fax: 9875 8778  
e-mail: contact@hhsurvey.com.au

ABN 80 006 516 169

<b>DRG. TITLE:</b> EXISTING LEVELS - 20/10/2017		
<b>SITE ADDRESS:</b> PALMERS ROAD, TRUGANINA		
<b>PROJECT NAME:</b> K & S CHEMTRANS		
<b>SITE MANAGER:</b> GARRY CROSS		
<b>DRAWN:</b> AV	<b>DRG. SCALE:</b> 1:400	<b>SOURCE OF DATA - DRG:</b> SURVEY
<b>OUR REF:</b> 7592	<b>DATE DRAWN:</b> 23/10/2017	<b>DATE OF FIELDWORK:</b> 20/10/2017

**NOTES:**

- TITLE BOUNDARY
- EDGE OF FORMWORK
- EXTENT OF CONCRETE THICKENING
- x—x—x— EXISTING SURFACE LEVEL
- x—x—x— CONCRETE PAVING LEVEL

x43.40  
x43.40

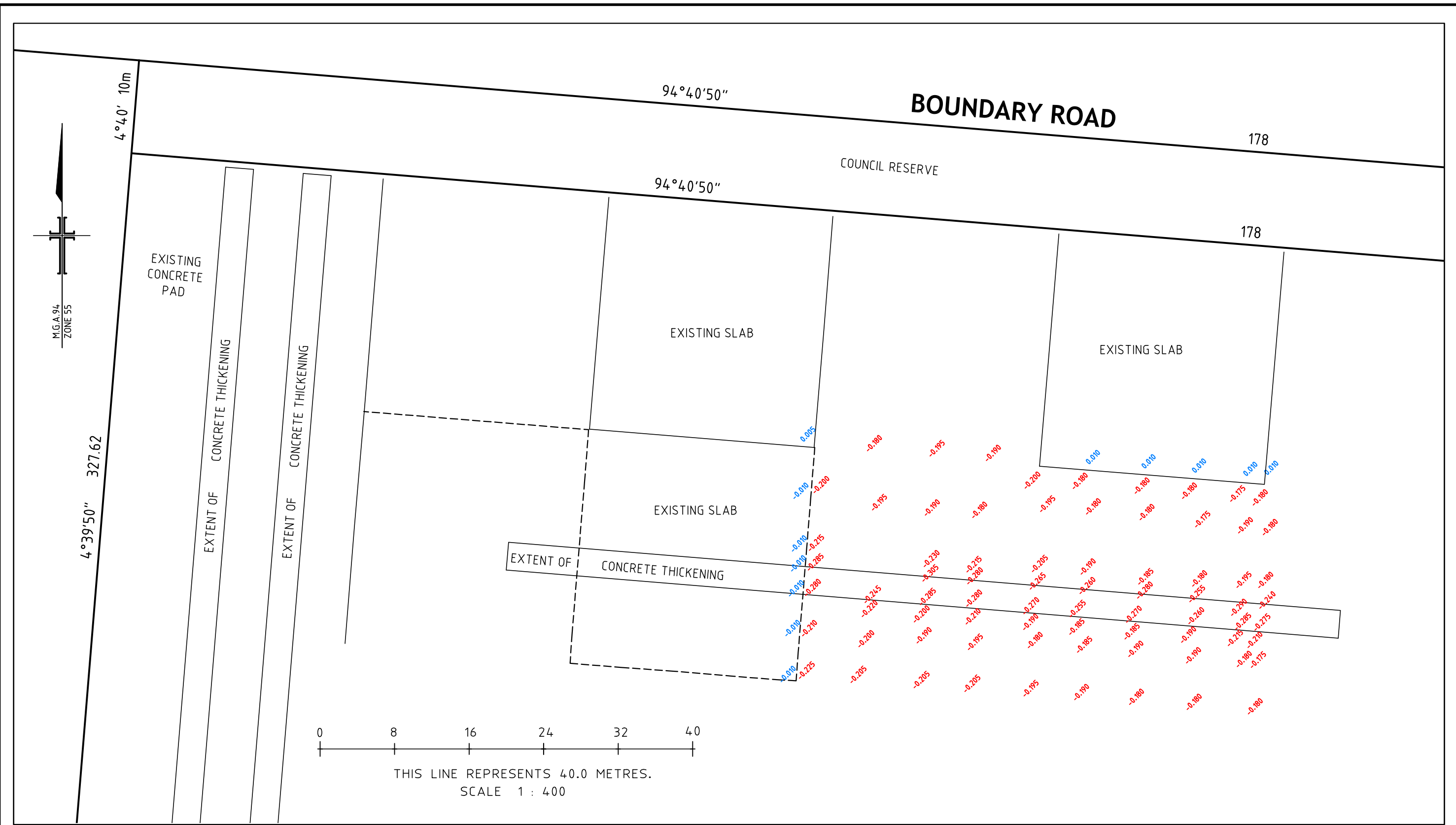

**CLIENT**



**VAUGHAN CONSTRUCTIONS PTY. LTD.**



**HEAD & HUMPHREYS LAND CONSULTANTS**  
 Suite 3, 47 Railway Road  
 P.O. Box 63, Blackburn 3130  
 Tel: 9875 8777 Fax: 9875 8778  
 e-mail: contact@hhsurvey.com.au

ABN 80 006 516 169

<b>DRG. TITLE:</b> CUT/FILL COMPARISON TO DESIGN LEVELS - 18/10/2017		
<b>SITE ADDRESS:</b> PALMERS ROAD, TRUGANINA		
<b>PROJECT NAME:</b> K & S CHEMTRANS		
<b>SITE MANAGER:</b> GARRY CROSS		
<b>DRAWN:</b> AV	<b>DRG. SCALE:</b> 1:400	<b>SOURCE OF DATA - DRG:</b> SURVEY & 14076-C02-H-Drainage & Pavement Layout Plan Sht.1
<b>OUR REF:</b> 7592	<b>DATE DRAWN:</b> 23/10/2017	<b>DATE OF FIELDWORK:</b> 20/10/2017

**NOTES:**

- TITLE BOUNDARY
- EDGE OF FORMWORK
- EXTENT OF CONCRETE THICKENING
- + - 0.18 HEIGHT DIFFERENCE TO DESIGN